

This drawing has been prepared for the use of AECOM's client. It may not be used, modified, reproduced or relied upon by third parties, except as agreed by AECOM or as required by law. AECOM accepts no responsibility, and denies any liability whatsoever, to any party that uses or relies on this drawing without AECOM's express written consent. Do not scale this document.



CONSULTANT

AECOM House, 63-77 Victoria Street,
St. Albans, Hertfordshire, AL1 3ER
+44(0)1727 535000 tel
+44(0)1727 535099 fax
www.aecom.com

PROJECT

Sunnica Energy Farm

CLIENT



NOTE

1. THE TRAFFIC REGULATION MEASURES PLANS SHOULD BE READ IN CONJUNCTION WITH THE DEVELOPMENT CONSENT ORDER AND THE OTHER PLANS AND DOCUMENTS TO BE CERTIFIED BY IT, IN PARTICULAR ARTICLES 11 AND 44 OF, AND SCHEDULES 6 AND 14 TO, THE DEVELOPMENT CONSENT ORDER.
2. THE INDICATIVE ACCESS LOCATIONS SHOWN ON THESE PLANS INDICATE THE GENERAL LOCATION OF THE ACCESSES TO WHICH THE TEMPORARY TRAFFIC SIGNAL MEASURES AND TEMPORARY PROHIBITION MEASURE DESCRIBED IN PARTS 2 AND 4 OF SCHEDULE 14 TO THE DEVELOPMENT CONSENT ORDER, RELATE. THESE PLANS DO NOT SHOW ALL PROPOSED ACCESSES TO THE AUTHORISED DEVELOPMENT. FURTHER INFORMATION ON THE PROPOSED ACCESSES TO THE AUTHORISED DEVELOPMENT CAN BE FOUND IN THE ACCESS AND RIGHTS OF WAY PLANS AND SCHEDULE 7 TO THE DRAFT DCO.
3. THE REQUIREMENT FOR TS1 HAS BEEN REMOVED AND TRAFFIC SIGNALS START AT TS2.

KEY

- ORDER LIMITS
- PROPOSED TEMPORARY SPEED LIMIT (30MPH SPEED LIMIT)
- PROPOSED TEMPORARY SPEED LIMIT (40MPH SPEED LIMIT)
- PROPOSED TEMPORARY TRAFFIC SIGNAL CONTROL AREA
- PROPOSED TEMPORARY PROHIBITION ORDER
- INDICATIVE SITE ACCESS LOCATION

Document Reference: EN010106/APP/2.4

ISSUE/REVISION

3	13/01/2023	CHANGE APPLICATION JANUARY 2023
2	11/11/2022	SUBMITTED AT DEADLINE 2
1	30/08/2022	CHANGE APPLICATION JULY 2022
0	18/11/2021	FOR DCO SUBMISSION
I/R	DATE	DESCRIPTION

SHEET TITLE

TRAFFIC REGULATION MEASURES PLANS -
TEMPORARY MEASURES
INFRASTRUCTURE PLANNING
(APPLICATIONS: PRESCRIBED FORMS AND
PROCEDURE) REGULATIONS 2009 5(2)(O)
SHEET PLAN

SHEET NUMBER

60589004-TRM-TM-000

SCALE

On drawing

This drawing includes Ordnance Survey material with the permission of Ordnance Survey on behalf of The Controller of Her Majesty's Stationery Office
© Crown copyright and database rights 2021. Ordnance Survey 0100031673.

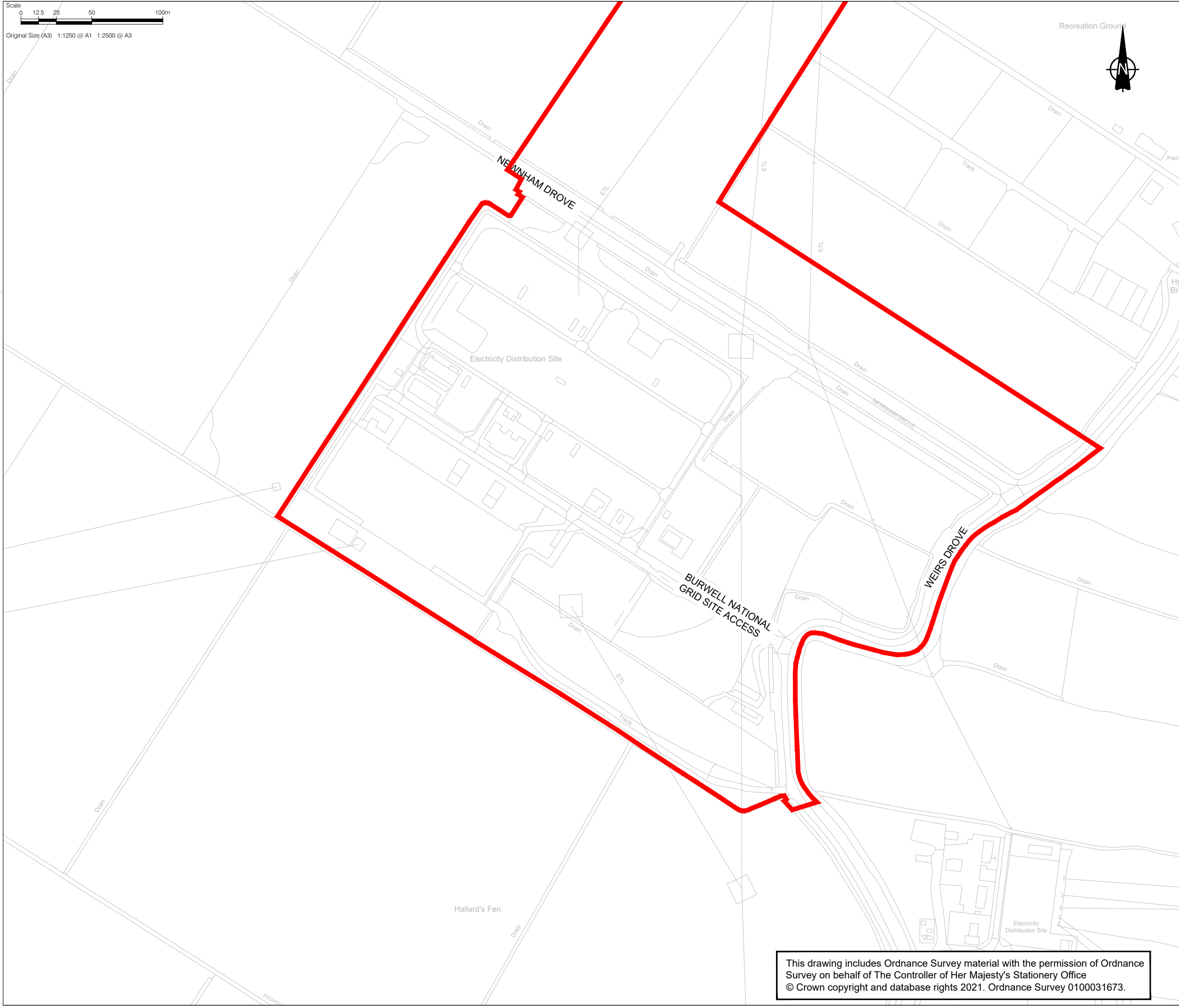

This drawing includes Ordnance Survey material with the permission of Ordnance Survey on behalf of The Controller of Her Majesty's Stationery Office
© Crown copyright and database rights 2021. Ordnance Survey 0100031673.

This drawing has been prepared for the use of AECOM's client. It may not be used, modified, reproduced or relied upon by third parties, except as agreed by AECOM or as required by law. AECOM accepts no responsibility, and denies any liability whatsoever, to any party that uses or relies on this drawing without AECOM's express written consent. Do not scale this document.



CONSULTANT

AECOM House, 63-77 Victoria Street,
St. Albans, Hertfordshire, AL1 3ER
+44(0)1727 535000 tel
+44(0)1727 535099 fax
www.aecom.com

PROJECT

Sunnica Energy Farm

CLIENT



NOTE

1. THE TRAFFIC REGULATION MEASURES PLANS SHOULD BE READ IN CONJUNCTION WITH THE DEVELOPMENT CONSENT ORDER AND THE OTHER PLANS AND DOCUMENTS TO BE CERTIFIED BY IT, IN PARTICULAR ARTICLES 11 AND 44 OF, AND SCHEDULES 6 AND 14 TO, THE DEVELOPMENT CONSENT ORDER.
2. THE INDICATIVE ACCESS LOCATIONS SHOWN ON THESE PLANS INDICATE THE GENERAL LOCATION OF THE ACCESSES TO WHICH THE TEMPORARY TRAFFIC SIGNAL MEASURES AND TEMPORARY PROHIBITION MEASURE DESCRIBED IN PARTS 2 AND 4 OF SCHEDULE 14 TO THE DEVELOPMENT CONSENT ORDER, RELATE. THESE PLANS DO NOT SHOW ALL PROPOSED ACCESSES TO THE AUTHORISED DEVELOPMENT. FURTHER INFORMATION ON THE PROPOSED ACCESSES TO THE AUTHORISED DEVELOPMENT CAN BE FOUND IN THE ACCESS AND RIGHTS OF WAY PLANS AND SCHEDULE 7 TO THE DRAFT DCO.
3. THE REQUIREMENT FOR TS1 HAS BEEN REMOVED AND TRAFFIC SIGNALS START AT TS2.

KEY

- ORDER LIMITS
- PROPOSED TEMPORARY SPEED LIMIT (30MPH SPEED LIMIT)
- PROPOSED TEMPORARY SPEED LIMIT (40MPH SPEED LIMIT)
- PROPOSED TEMPORARY TRAFFIC SIGNAL CONTROL AREA
- PROPOSED TEMPORARY PROHIBITION ORDER
- INDICATIVE SITE ACCESS LOCATION

SHEET PLAN

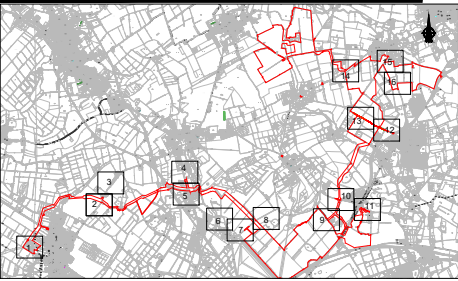

ISSUE/REVISION

I/R	DATE	DESCRIPTION
3	13/01/2023	CHANGE APPLICATION JANUARY 2023
2	11/11/2022	SUBMITTED AT DEADLINE 2
1	30/08/2022	CHANGE APPLICATION JULY 2022
0	18/11/2021	FOR DCO SUBMISSION

SHEET TITLE

TRAFFIC REGULATION MEASURES PLANS -
TEMPORARY MEASURES
INFRASTRUCTURE PLANNING
(APPLICATIONS: PRESCRIBED FORMS AND
PROCEDURE) REGULATIONS 2009 5(2)(O)
SHEET 1 OF 16

SHEET NUMBER

60589004-TRM-TM-001

SCALE

1:2500 @ A3
Document Reference: EN010106/APP/2.4

Project Management Initials: Designer: DC
Latest Revision Initials: Checked: CC
Project Reference Number: 60589004

Last saved by: HATTONCM(2023-01-06) Last Plotted: 2023-01-06
Filename: \\NA.AECOM\NET\COM\FS\EN\EA\ST\ALBANS\UNST\1\LEGACY\DP\PROJECTS\SUNNICA ENERGY FARMES APPLICATION\CA\T\TROS2.WP1\TRAFFIC REGULATION MEASURES_S\SHEETS_TM.DWG

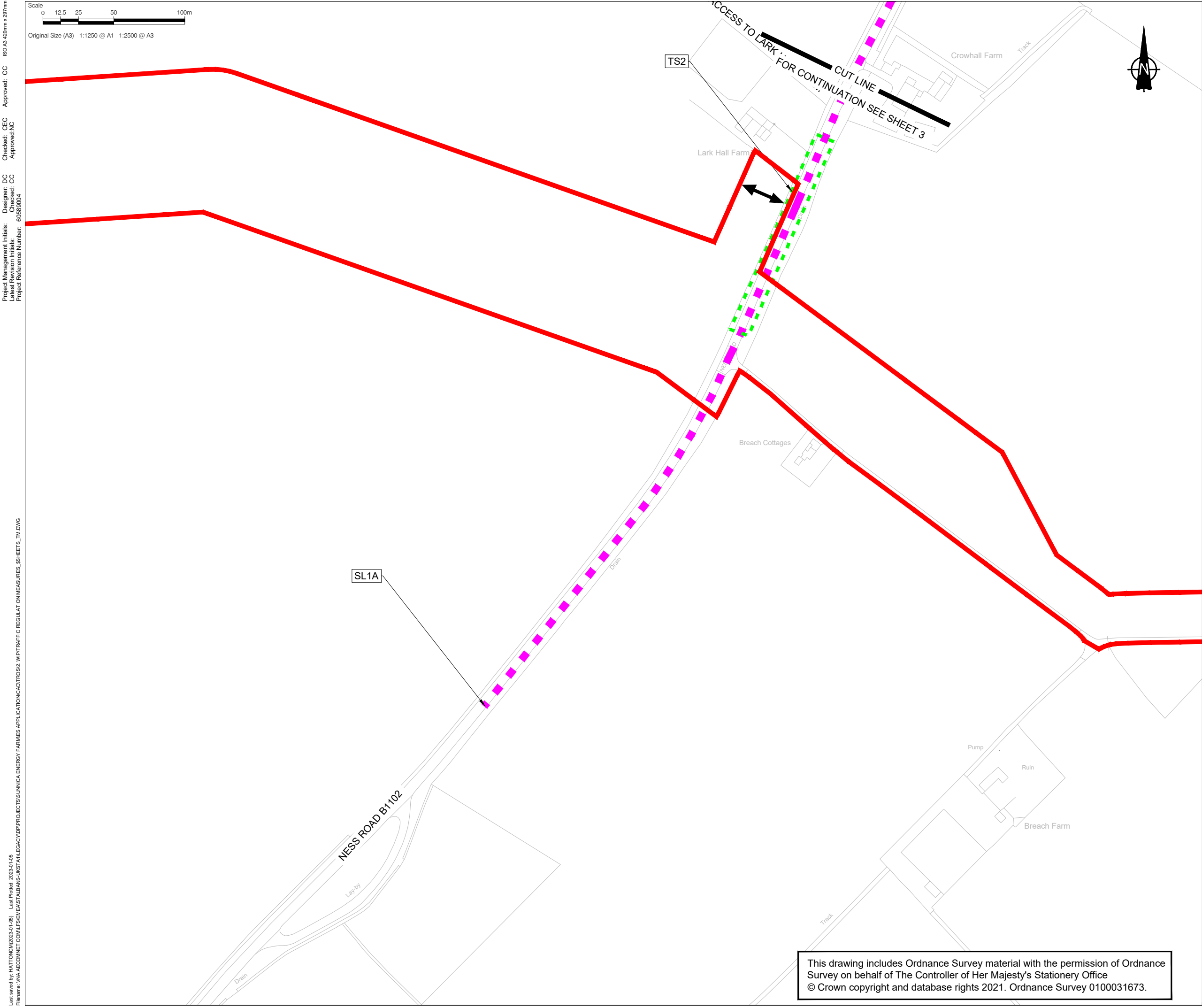

This drawing includes Ordnance Survey material with the permission of Ordnance Survey on behalf of The Controller of Her Majesty's Stationery Office
© Crown copyright and database rights 2021. Ordnance Survey 0100031673.

This drawing has been prepared for the use of AECOM's client. It may not be used, modified, reproduced or relied upon by third parties, except as agreed by AECOM or as required by law. AECOM accepts no responsibility, and denies any liability whatsoever, to any party that uses or relies on this drawing without AECOM's express written consent. Do not scale this document.



CONSULTANT

AECOM House, 63-77 Victoria Street,
St. Albans, Hertfordshire, AL1 3ER
+44(0)1727 535000 tel
+44(0)1727 535099 fax
www.aecom.com

PROJECT

Sunnica Energy Farm

CLIENT



NOTE

1. THE TRAFFIC REGULATION MEASURES PLANS SHOULD BE READ IN CONJUNCTION WITH THE DEVELOPMENT CONSENT ORDER AND THE OTHER PLANS AND DOCUMENTS TO BE CERTIFIED BY IT, IN PARTICULAR ARTICLES 11 AND 44 OF, AND SCHEDULES 6 AND 14 TO, THE DEVELOPMENT CONSENT ORDER.
2. THE INDICATIVE ACCESS LOCATIONS SHOWN ON THESE PLANS INDICATE THE GENERAL LOCATION OF THE ACCESSES TO WHICH THE TEMPORARY TRAFFIC SIGNAL MEASURES AND TEMPORARY PROHIBITION MEASURE DESCRIBED IN PARTS 2 AND 4 OF SCHEDULE 14 TO THE DEVELOPMENT CONSENT ORDER, RELATE. THESE PLANS DO NOT SHOW ALL PROPOSED ACCESSES TO THE AUTHORISED DEVELOPMENT. FURTHER INFORMATION ON THE PROPOSED ACCESSES TO THE AUTHORISED DEVELOPMENT CAN BE FOUND IN THE ACCESS AND RIGHTS OF WAY PLANS AND SCHEDULE 7 TO THE DRAFT DCO.
3. THE REQUIREMENT FOR TS1 HAS BEEN REMOVED AND TRAFFIC SIGNALS START AT TS2.

KEY

- ORDER LIMITS
- - - PROPOSED TEMPORARY SPEED LIMIT (30MPH SPEED LIMIT)
- - - PROPOSED TEMPORARY SPEED LIMIT (40MPH SPEED LIMIT)
- - - PROPOSED TEMPORARY TRAFFIC SIGNAL CONTROL AREA
- - - PROPOSED TEMPORARY PROHIBITION ORDER
- ↔ INDICATIVE SITE ACCESS LOCATION

SHEET PLAN

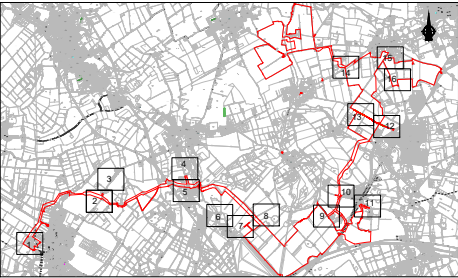

ISSUE/REVISION

3	13/01/2023	CHANGE APPLICATION JANUARY 2023
2	11/11/2022	SUBMITTED AT DEADLINE 2
1	30/08/2022	CHANGE APPLICATION JULY 2022
0	18/11/2021	FOR DCO SUBMISSION
I/R	DATE	DESCRIPTION

SHEET TITLE

TRAFFIC REGULATION MEASURES PLANS -
TEMPORARY MEASURES
INFRASTRUCTURE PLANNING
(APPLICATIONS: PRESCRIBED FORMS AND
PROCEDURE) REGULATIONS 2009 5(2)(O)
SHEET 2 OF 16

SHEET NUMBER

60589004-TRM-TM-002

SCALE

1:2500 @ A3
Document Reference: EN010106/APP/2.4

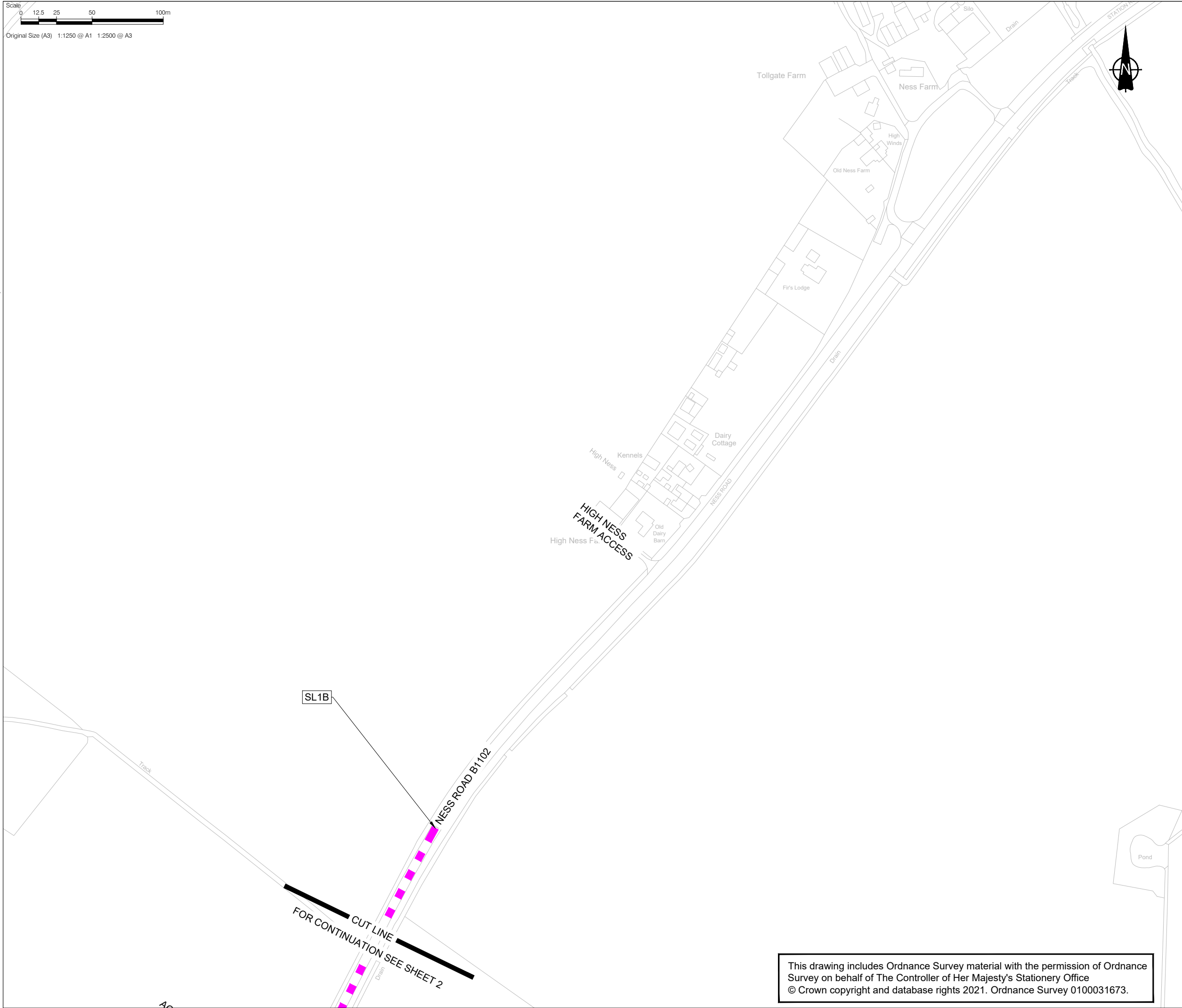

This drawing includes Ordnance Survey material with the permission of Ordnance Survey on behalf of The Controller of Her Majesty's Stationery Office
© Crown copyright and database rights 2021. Ordnance Survey 0100031673.

This drawing has been prepared for the use of AECOM's client. It may not be used, modified, reproduced or relied upon by third parties, except as agreed by AECOM or as required by law. AECOM accepts no responsibility, and denies any liability whatsoever, to any party that uses or relies on this drawing without AECOM's express written consent. Do not scale this document.



CONSULTANT

AECOM House, 63-77 Victoria Street,
St. Albans, Hertfordshire, AL1 3ER
+44(0)1727 535000 tel
+44(0)1727 535099 fax
www.aecom.com

PROJECT

Sunnica Energy Farm

CLIENT



NOTE

1. THE TRAFFIC REGULATION MEASURES PLANS SHOULD BE READ IN CONJUNCTION WITH THE DEVELOPMENT CONSENT ORDER AND THE OTHER PLANS AND DOCUMENTS TO BE CERTIFIED BY IT, IN PARTICULAR ARTICLES 11 AND 44 OF, AND SCHEDULES 6 AND 14 TO, THE DEVELOPMENT CONSENT ORDER.
2. THE INDICATIVE ACCESS LOCATIONS SHOWN ON THESE PLANS INDICATE THE GENERAL LOCATION OF THE ACCESSES TO WHICH THE TEMPORARY TRAFFIC SIGNAL MEASURES AND TEMPORARY PROHIBITION MEASURE DESCRIBED IN PARTS 2 AND 4 OF SCHEDULE 14 TO THE DEVELOPMENT CONSENT ORDER, RELATE. THESE PLANS DO NOT SHOW ALL PROPOSED ACCESSES TO THE AUTHORISED DEVELOPMENT. FURTHER INFORMATION ON THE PROPOSED ACCESSES TO THE AUTHORISED DEVELOPMENT CAN BE FOUND IN THE ACCESS AND RIGHTS OF WAY PLANS AND SCHEDULE 7 TO THE DRAFT DCO.
3. THE REQUIREMENT FOR TS1 HAS BEEN REMOVED AND TRAFFIC SIGNALS START AT TS2.

KEY

- ORDER LIMITS
- PROPOSED TEMPORARY SPEED LIMIT (30MPH SPEED LIMIT)
- PROPOSED TEMPORARY SPEED LIMIT (40MPH SPEED LIMIT)
- PROPOSED TEMPORARY TRAFFIC SIGNAL CONTROL AREA
- PROPOSED TEMPORARY PROHIBITION ORDER
- ➡ INDICATIVE SITE ACCESS LOCATION

SHEET PLAN

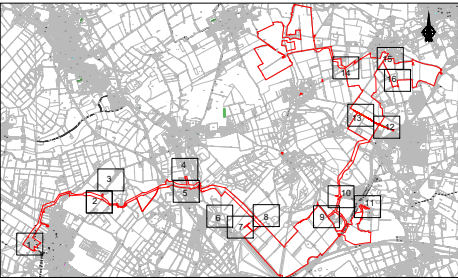

ISSUE/REVISION

3	13/01/2023	CHANGE APPLICATION JANUARY 2023
2	11/11/2022	SUBMITTED AT DEADLINE 2
1	30/08/2022	CHANGE APPLICATION JULY 2022
0	18/11/2021	FOR DCO SUBMISSION
I/R	DATE	DESCRIPTION

SHEET TITLE

TRAFFIC REGULATION MEASURES PLANS -
TEMPORARY MEASURES
INFRASTRUCTURE PLANNING
(APPLICATIONS: PRESCRIBED FORMS AND
PROCEDURE) REGULATIONS 2009 5(2)(O)
SHEET 3 OF 16

SHEET NUMBER

60589004-TRM-TM-003

SCALE

1:2500 @ A3
Document Reference: EN010106/APP/2.4

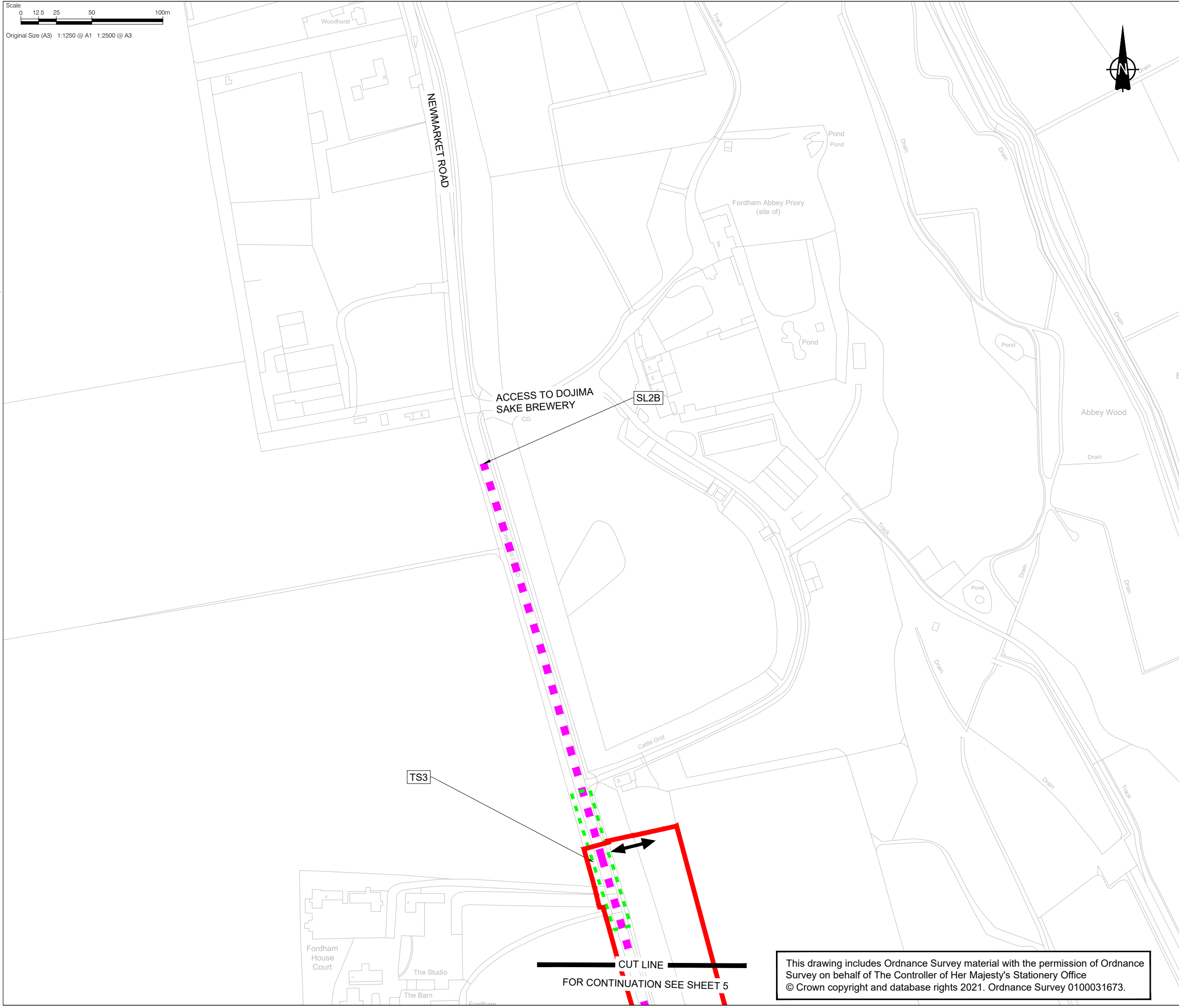

CONSULTANT

AECOM House, 63-77 Victoria Street,
St. Albans, Hertfordshire, AL1 3ER
+44(0)1727 535000 tel
+44(0)1727 535099 fax
www.aecom.com

PROJECT

Sunnica Energy Farm

CLIENT



NOTE

1. THE TRAFFIC REGULATION MEASURES PLANS SHOULD BE READ IN CONJUNCTION WITH THE DEVELOPMENT CONSENT ORDER AND THE OTHER PLANS AND DOCUMENTS TO BE CERTIFIED BY IT, IN PARTICULAR ARTICLES 11 AND 44 OF, AND SCHEDULES 6 AND 14 TO, THE DEVELOPMENT CONSENT ORDER.
2. THE INDICATIVE ACCESS LOCATIONS SHOWN ON THESE PLANS INDICATE THE GENERAL LOCATION OF THE ACCESSES TO WHICH THE TEMPORARY TRAFFIC SIGNAL MEASURES AND TEMPORARY PROHIBITION MEASURE DESCRIBED IN PARTS 2 AND 4 OF SCHEDULE 14 TO THE DEVELOPMENT CONSENT ORDER, RELATE. THESE PLANS DO NOT SHOW ALL PROPOSED ACCESSES TO THE AUTHORISED DEVELOPMENT. FURTHER INFORMATION ON THE PROPOSED ACCESSES TO THE AUTHORISED DEVELOPMENT CAN BE FOUND IN THE ACCESS AND RIGHTS OF WAY PLANS AND SCHEDULE 7 TO THE DRAFT DCO.
3. THE REQUIREMENT FOR TS1 HAS BEEN REMOVED AND TRAFFIC SIGNALS START AT TS2.

KEY

- ORDER LIMITS
- PROPOSED TEMPORARY SPEED LIMIT (30MPH SPEED LIMIT)
- PROPOSED TEMPORARY SPEED LIMIT (40MPH SPEED LIMIT)
- PROPOSED TEMPORARY TRAFFIC SIGNAL CONTROL AREA
- PROPOSED TEMPORARY PROHIBITION ORDER
- INDICATIVE SITE ACCESS LOCATION

SHEET PLAN

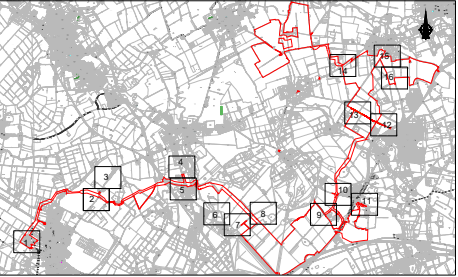

ISSUE/REVISION

I/R	DATE	DESCRIPTION
3	13/01/2023	CHANGE APPLICATION JANUARY 2023
2	11/11/2022	SUBMITTED AT DEADLINE 2
1	30/08/2022	CHANGE APPLICATION JULY 2022
0	18/11/2021	FOR DCO SUBMISSION

SHEET TITLE

TRAFFIC REGULATION MEASURES PLANS -
TEMPORARY MEASURES
INFRASTRUCTURE PLANNING
(APPLICATIONS: PRESCRIBED FORMS AND
PROCEDURE) REGULATIONS 2009 5(2)(O)
SHEET 4 OF 16

SHEET NUMBER

60589004-TRM-TM-004

SCALE

1:2500 @ A3
Document Reference: EN010106/APP/2.4

This drawing includes Ordnance Survey material with the permission of Ordnance Survey on behalf of The Controller of Her Majesty's Stationery Office
© Crown copyright and database rights 2021. Ordnance Survey 0100031673.

Project Management Initials: Designer: DC Checked: CC Latest Revision Initials: Checked: CC Project Reference Number: 60589004
Last saved by: HATTONCM(2023-01-06) Last Printed: 2023-01-06
Filename: \\NA.AECOM\NET\COM\FSE\ENEA\STALBANS\UNST\1\LEGACY\PROJECTS\UNNICA ENERGY FARMES APPLICATION\CAD\TROSS.WIP\TRAFFIC REGULATION MEASURES_SHEETS_TM.DWG
Printed on 81% Post-Consumer Recycled Content Paper

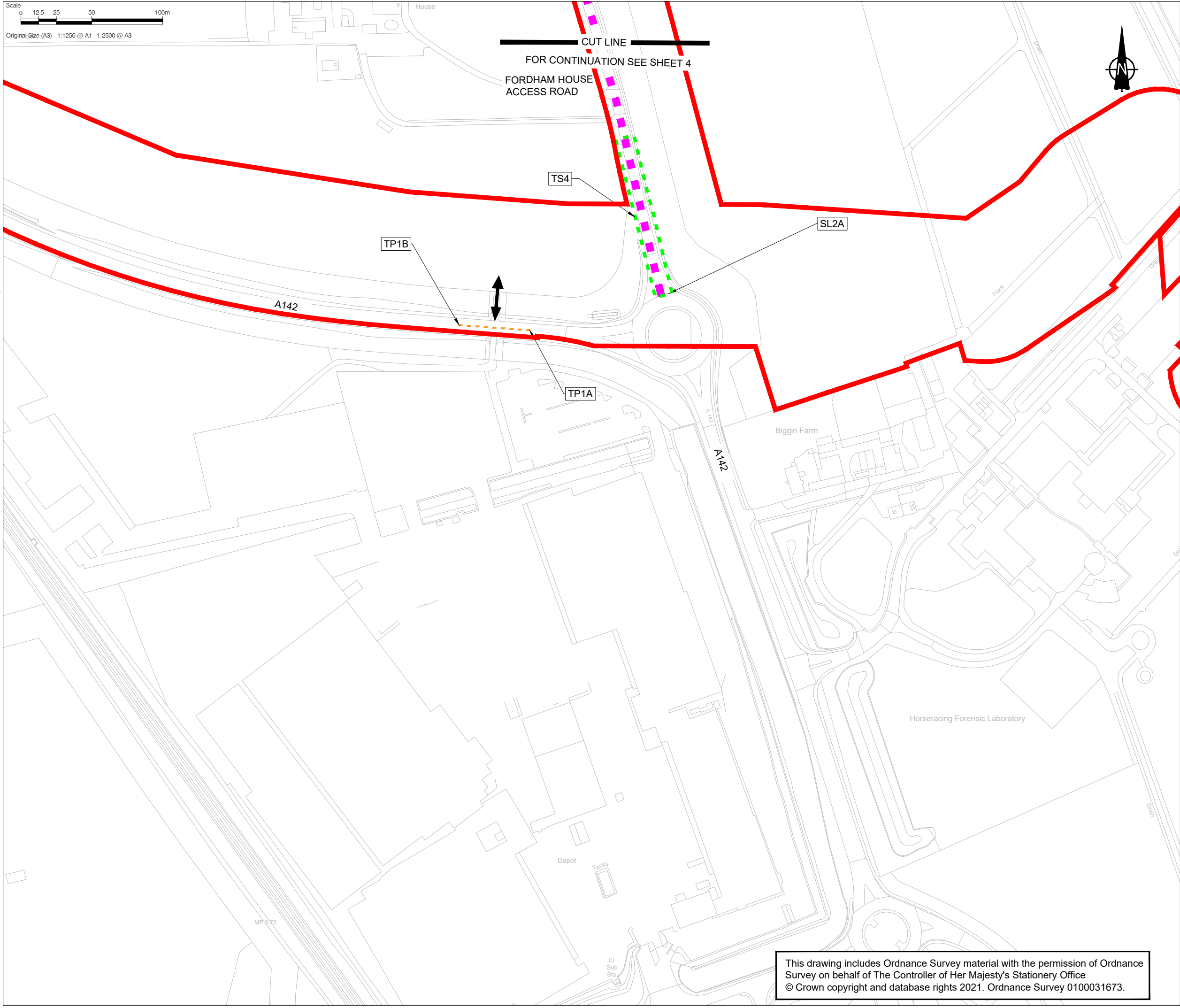

This drawing includes Ordnance Survey material with the permission of Ordnance Survey on behalf of The Controller of Her Majesty's Stationery Office
© Crown copyright and database rights 2021. Ordnance Survey 0100031673.

This drawing has been prepared for the use of AECOM's client. It may not be used, modified, reproduced or relied upon by third parties, except as agreed by AECOM or as required by law. AECOM accepts no responsibility, and denies any liability whatsoever, to any party that uses or relies on this drawing without AECOM's express written consent. Do not scale this document.

AECOM

CONSULTANT

AECOM House, 63-77 Victoria Street,
St. Albans, Hertfordshire, AL1 3ER
+44(0)1727 535000 tel
+44(0)1727 535099 fax
www.aecom.com

PROJECT

Sunnica Energy Farm

CLIENT



sunnica
energy farm

NOTE

1. THE TRAFFIC REGULATION MEASURES PLANS SHOULD BE READ IN CONJUNCTION WITH THE DEVELOPMENT CONSENT ORDER AND THE OTHER PLANS AND DOCUMENTS TO BE CERTIFIED BY IT, IN PARTICULAR ARTICLES 11 AND 44 OF, AND SCHEDULES 6 AND 14 TO, THE DEVELOPMENT CONSENT ORDER.
2. THE INDICATIVE ACCESS LOCATIONS SHOWN ON THESE PLANS INDICATE THE GENERAL LOCATION OF THE ACCESSES TO WHICH THE TEMPORARY TRAFFIC SIGNAL MEASURES AND TEMPORARY PROHIBITION MEASURE DESCRIBED IN PARTS 2 AND 4 OF SCHEDULE 14 TO THE DEVELOPMENT CONSENT ORDER, RELATE. THESE PLANS DO NOT SHOW ALL PROPOSED ACCESSES TO THE AUTHORISED DEVELOPMENT. FURTHER INFORMATION ON THE PROPOSED ACCESSES TO THE AUTHORISED DEVELOPMENT CAN BE FOUND IN THE ACCESS AND RIGHTS OF WAY PLANS AND SCHEDULE 7 TO THE DRAFT DCO.
3. THE REQUIREMENT FOR TS1 HAS BEEN REMOVED AND TRAFFIC SIGNALS START AT TS2.

KEY

- ORDER LIMITS
- PROPOSED TEMPORARY SPEED LIMIT (30MPH SPEED LIMIT)
- PROPOSED TEMPORARY SPEED LIMIT (40MPH SPEED LIMIT)
- PROPOSED TEMPORARY TRAFFIC SIGNAL CONTROL AREA
- PROPOSED TEMPORARY PROHIBITION ORDER
- ↔ INDICATIVE SITE ACCESS LOCATION

SHEET PLAN

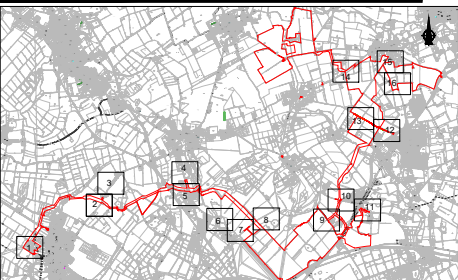

ISSUE/REVISION

I/R	DATE	DESCRIPTION
3	13/01/2023	CHANGE APPLICATION JANUARY 2023
2	11/11/2022	SUBMITTED AT DEADLINE 2
1	30/08/2022	CHANGE APPLICATION JULY 2022
0	18/11/2021	FOR DCO SUBMISSION

SHEET TITLE

TRAFFIC REGULATION MEASURES PLANS -
TEMPORARY MEASURES
INFRASTRUCTURE PLANNING
(APPLICATIONS: PRESCRIBED FORMS AND
PROCEDURE) REGULATIONS 2009 5(2)(O)
SHEET 5 OF 16

SHEET NUMBER

60589004-TRM-TM-005

SCALE

1:2500 @ A3
Document Reference: EN010106/APP/2.4



This drawing includes Ordnance Survey material with the permission of Ordnance Survey on behalf of The Controller of Her Majesty's Stationery Office
© Crown copyright and database rights 2021. Ordnance Survey 0100031673.

This drawing has been prepared for the use of AECOM's client. It may not be used, modified, reproduced or relied upon by third parties, except as agreed by AECOM or as required by law. AECOM accepts no responsibility, and denies any liability whatsoever, to any party that uses or relies on this drawing without AECOM's express written consent. Do not scale this document.



CONSULTANT

AECOM House, 63-77 Victoria Street,
St. Albans, Hertfordshire, AL1 3ER
+44(0)1727 535000 tel
+44(0)1727 535099 fax
www.aecom.com

PROJECT

Sunnica Energy Farm

CLIENT



NOTE

1. THE TRAFFIC REGULATION MEASURES PLANS SHOULD BE READ IN CONJUNCTION WITH THE DEVELOPMENT CONSENT ORDER AND THE OTHER PLANS AND DOCUMENTS TO BE CERTIFIED BY IT, IN PARTICULAR ARTICLES 11 AND 44 OF, AND SCHEDULES 6 AND 14 TO, THE DEVELOPMENT CONSENT ORDER.
2. THE INDICATIVE ACCESS LOCATIONS SHOWN ON THESE PLANS INDICATE THE GENERAL LOCATION OF THE ACCESSES TO WHICH THE TEMPORARY TRAFFIC SIGNAL MEASURES AND TEMPORARY PROHIBITION MEASURE DESCRIBED IN PARTS 2 AND 4 OF SCHEDULE 14 TO THE DEVELOPMENT CONSENT ORDER, RELATE. THESE PLANS DO NOT SHOW ALL PROPOSED ACCESSES TO THE AUTHORISED DEVELOPMENT. FURTHER INFORMATION ON THE PROPOSED ACCESSES TO THE AUTHORISED DEVELOPMENT CAN BE FOUND IN THE ACCESS AND RIGHTS OF WAY PLANS AND SCHEDULE 7 TO THE DRAFT DCO.
3. THE SHEET INTENTIONALLY DOES NOT INCLUDE ANY MEASURES.

KEY

SHEET PLAN

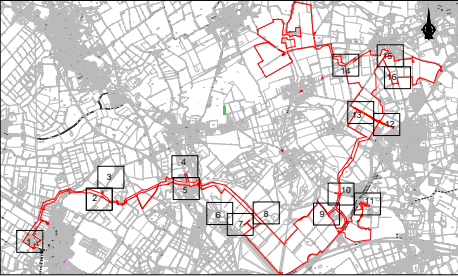

ISSUE/REVISION

3	13/01/2023	CHANGE APPLICATION JANUARY 2023
2	11/11/2022	SUBMITTED AT DEADLINE 2
1	30/08/2022	CHANGE APPLICATION JULY 2022
0	18/11/2021	FOR DCO SUBMISSION
I/R	DATE	DESCRIPTION

SHEET TITLE

TRAFFIC REGULATION MEASURES PLANS -
TEMPORARY MEASURES
INFRASTRUCTURE PLANNING
(APPLICATIONS: PRESCRIBED FORMS AND
PROCEDURE) REGULATIONS 2009 5(2)(O)
SHEET 6 OF 16

SHEET NUMBER

60589004-TRM-TM-006

SCALE

1:2500 @ A3
Document Reference: EN010106/APP/2.4

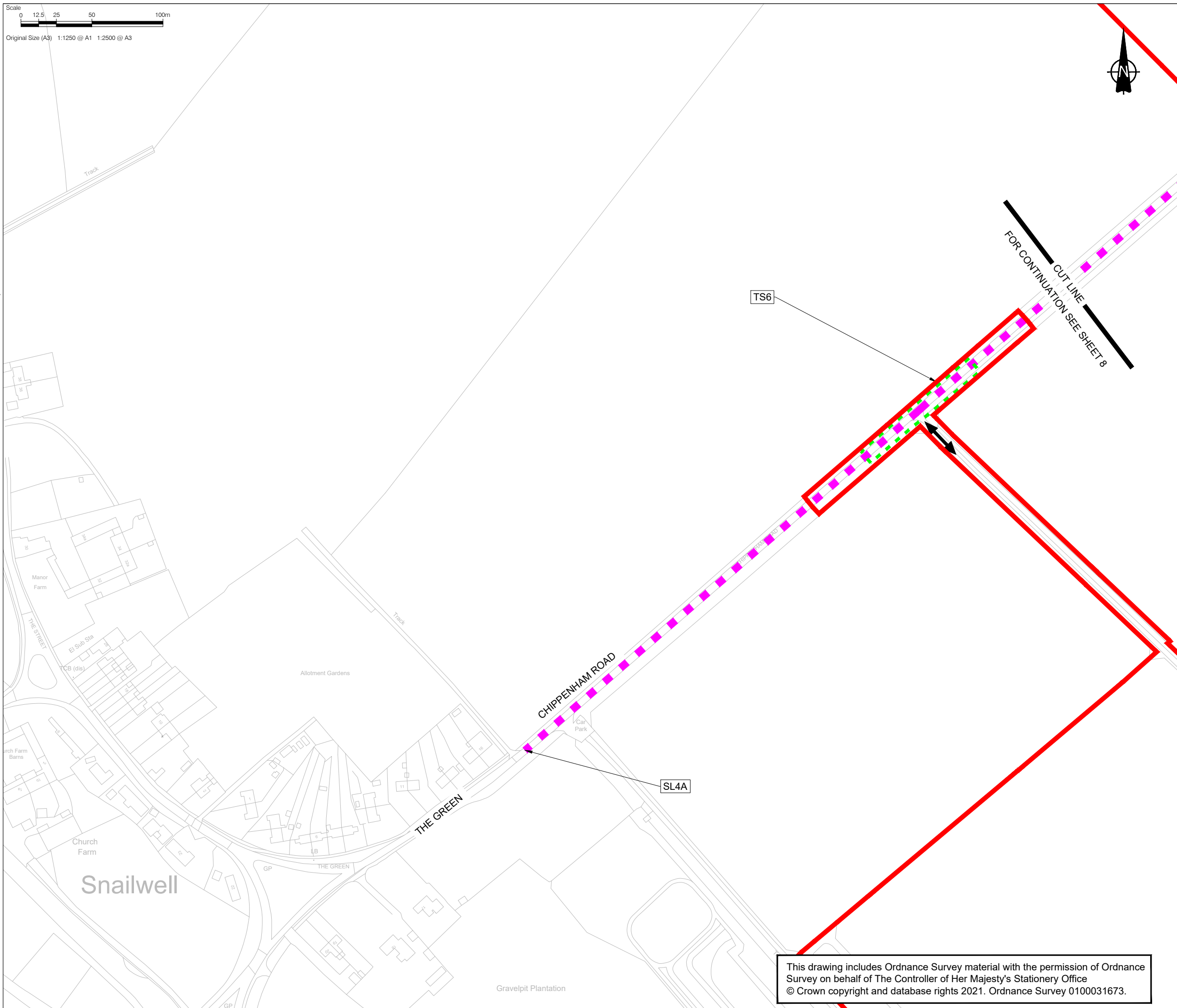

CONSULTANT

AECOM House, 63-77 Victoria Street,
St. Albans, Hertfordshire, AL1 3ER
+44(0)1727 535000 tel
+44(0)1727 535099 fax
www.aecom.com

PROJECT

Sunnica Energy Farm





CLIENT



NOTE

1. THE TRAFFIC REGULATION MEASURES PLANS SHOULD BE READ IN CONJUNCTION WITH THE DEVELOPMENT CONSENT ORDER AND THE OTHER PLANS AND DOCUMENTS TO BE CERTIFIED BY IT, IN PARTICULAR ARTICLES 11 AND 44 OF, AND SCHEDULES 6 AND 14 TO, THE DEVELOPMENT CONSENT ORDER.
2. THE INDICATIVE ACCESS LOCATIONS SHOWN ON THESE PLANS INDICATE THE GENERAL LOCATION OF THE ACCESSES TO WHICH THE TEMPORARY TRAFFIC SIGNAL MEASURES AND TEMPORARY PROHIBITION MEASURE DESCRIBED IN PARTS 2 AND 4 OF SCHEDULE 14 TO THE DEVELOPMENT CONSENT ORDER, RELATE. THESE PLANS DO NOT SHOW ALL PROPOSED ACCESSES TO THE AUTHORISED DEVELOPMENT. FURTHER INFORMATION ON THE PROPOSED ACCESSES TO THE AUTHORISED DEVELOPMENT CAN BE FOUND IN THE ACCESS AND RIGHTS OF WAY PLANS AND SCHEDULE 7 TO THE DRAFT DCO.
3. THE REQUIREMENT FOR TS1 HAS BEEN REMOVED AND TRAFFIC SIGNALS START AT TS2.

KEY

-  ORDER LIMITS
 PROPOSED TEMPORARY SPEED LIMIT (30MPH SPEED LIMIT)
 PROPOSED TEMPORARY SPEED LIMIT (40MPH SPEED LIMIT)
 PROPOSED TEMPORARY TRAFFIC SIGNAL CONTROL AREA
 PROPOSED TEMPORARY PROHIBITION ORDER
 INDICATIVE SITE ACCESS LOCATION

SHEET PLAN

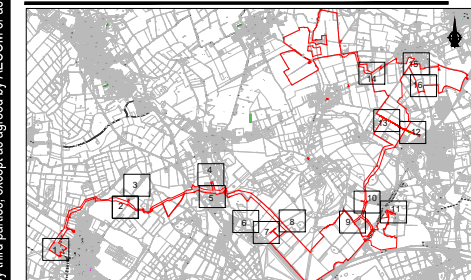

ISSUE/REVISION

3	13/01/2023	CHANGE APPLICATION JANUARY 2023
2	11/11/2022	SUBMITTED AT DEADLINE 2
1	30/08/2022	CHANGE APPLICATION JULY 2022
0	18/11/2021	FOR DCO SUBMISSION
I/R	DATE	DESCRIPTION

SHEET TITLE

TRAFFIC REGULATION MEASURES PLANS -
TEMPORARY MEASURES
INFRASTRUCTURE PLANNING
(APPLICATIONS: PRESCRIBED FORMS AND
PROCEDURE) REGULATIONS 2009 5(2)(O)
SHEET 7 OF 16

SHEET NUMBER

60589004-TRM-TM-007

SCALE

1:2500 @ A3

Document Reference: EN010106/APP/2.4

This drawing has been prepared for the use of AECOM's client. It may not be used, modified, reproduced or relied upon by third parties, except as agreed by AECOM or as required by law. AECOM accepts no responsibility, and denies any liability whatsoever, to any party that uses or relies on this drawing without AECOM's express written consent. Do not scale this document.